

LED LAMP

SPECIFICATIONS

Ideal For

6 Inch Retrofit Trim

Bright White
3000K

Features

- High Output Bright LEDs
- High CRI Shows True and Natural Colors
- Unique Square Shape
- 30,000 Hour Life
- RoHS Compliant
- 5 Year Warranty
- Suitable For Wet Locations
- UL/CUL Listed
- Title 24 Compliant

Housing Compatibility

- Suitable for type IC, type Non-IC and Air Tight Housings

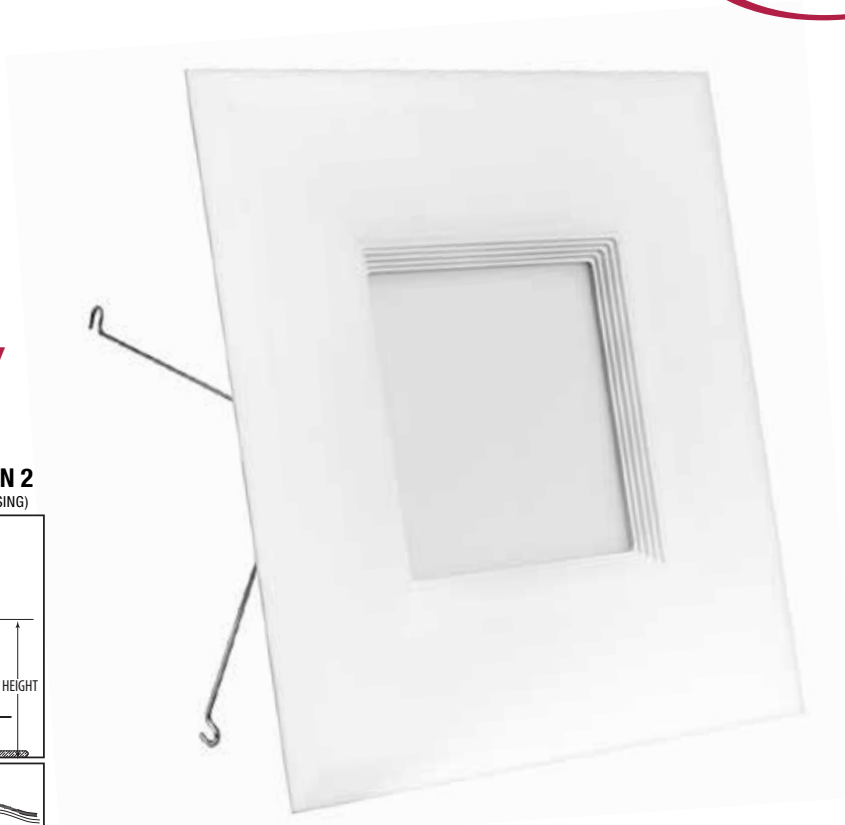

EASY INSTALLATION 1 (WITH EZ CONNECT HOUSING)

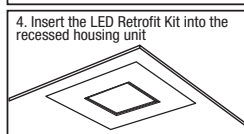
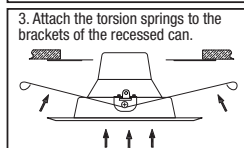
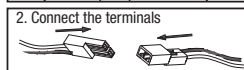
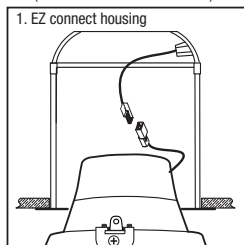

EASY INSTALLATION 2 (WITH STANDARD SOCKET HOUSING)

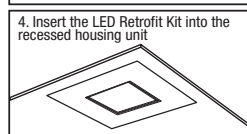
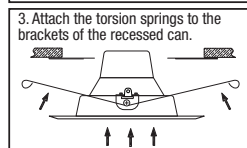
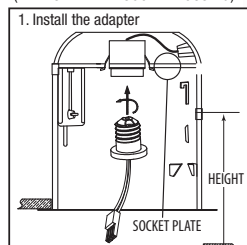

LIGHTING DISTRIBUTION		
	Center Beam (Foot Candles)	Beam Diameter
3 ft	43	8.4 ft
5 ft	15	14 ft
8 ft	6.0	22 ft
15 ft	1.7	42 ft

Beam Angle = 109°

Specifications

Item Number	Input Power (Watts)	Incandescent Equiv. (Watts)	Input Line Voltage
LEDRSQ6/930	11.3	65	120
Base Type	Lumens	Lumen Efficiency (LPW)	CCT
E26 Adapter	850	75	3000K
CRI	Housing	Life Hours	
90+	Fits 6" housings	30,000	